

OR600ERM1U/OR1000ERM1U
OR1500ERM1U

RELIABLE UPS TO PROTECT OFFICE EQUIPMENT

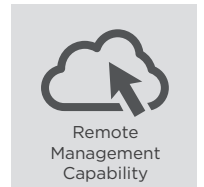
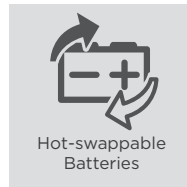
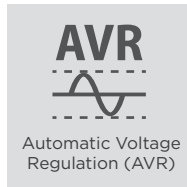
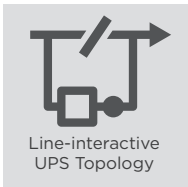

The line-interactive UPS with energy-saving technology for IT devices

Designed for office and server room applications, the Office Rackmount Series is a reliable UPS which adopts line-interactive topology with Automatic Voltage Regulation (AVR) function to offer stabilized AC power output. It features simulated sine wave output, and hot-swappable battery packs for simple maintenance. The power management software can also easily control and monitor the UPS system.

SERIES FEATURES

- Line-interactive UPS Topology
- Energy Saving Technology
- Simulated Sine Wave Output
- Automatic Voltage Regulation (AVR)
- Overload Protection
- Hot-swappable Batteries
- Surge and Spike Protection
- EMI and RFI Filtration
- LCD Status Display
- USB Connectivity Port
- PowerPanel Management Software
- SNMP/HTTP Remote Management Capability (Optional)

PRODUCT CALLOUTS

1. Power On Indicator
2. Power On/Off Switch
3. LCD Display Panel
4. Function Button(s)
5. Battery Backup & Surge Protected Outlets
6. Surge Protected Outlets
7. Communication Protection Ports RJ45
8. Input Circuit Breaker
9. AC Inlet
10. Serial Port
11. USB Port
12. SNMP/HTTP Network Slot

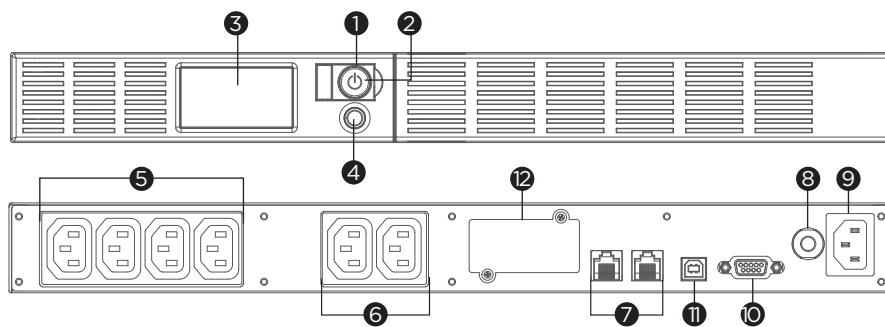

OR600/1000/1500ERM1U



TECHNICAL SPECIFICATIONS

Model Name	OR600ERM1U	OR1000ERM1U	OR1500ERM1U
General			
UPS Topology	Line-interactive		
Energy Saving Technology	GreenPower UPS™ Bypass Technology		
Input			
Nominal Input Voltage (Vac)	220, 230, 240		
Input Voltage Range (Vac)	165 - 271		
Input Frequency (Hz)	50 ± 3, 60 ± 3		
Input Frequency Detection	Auto-sensing		
Rated Input Current (A)	10		
Input Connector Type	IEC C14		
Output			
Capacity (VA)	600	1000	1500
Capacity (Watts)	360	600	900
On Battery Waveform	Simulated Sine Wave		
On Battery Voltage(s) (Vac)	230 ± 10		
On Battery Frequency (Hz)	50 ± 1%, 60 ± 1%		
Automatic Voltage Regulation (AVR)	Single Boost		
Overload Protection	Internal Current Limiting, Circuit Breaker		
Outlet(s) - Total	6		
Outlet Type	IEC C13 x 6		
Outlet(s) - Battery & Surge Protected	4		
Outlet(s) - Surge-Only Protected	2		
Typical Transfer Time (ms)	4		
Battery			
Runtime at Half Load (min)	13	14	11
Runtime at Full Load (min)	4	3.5	2.5
Typical Recharge Time (Hours)	8		
User-replaceable	Yes		
Hot-swappable	Yes		
Battery Type	Sealed Lead-acid		
Replacement Battery Pack (RBP)	RBPO019	RBPO025	RBPO026
Replacement Battery Pack (RBP) Quantity (pcs)	1		
Surge Protection & Filtering			
Surge Suppression (Joules)	405	810	
EMI/RFI Filtration	Yes		
Network Protection RJ45	1-in, 1-out		
Management & Communications			
LCD Panel	Yes		
HID Compliant USB Port(s)	1		
Serial Port	Dry Contact		
Power Management Software	PowerPanel Business (Recommended)		
SNMP/HTTP Remote Monitoring	Yes - with optional RMCARD205		
Physical			
Form Factor	Rackmount		
Physical Size - UPS Module			
Dimensions (WxHxD) (mm.)	433 x 44 x 235	433 x 44 x 389	
Weight (kg.)	7.8	13.7	14.9
Installed Rack Height (U)	1		
Environmental			
Operating Temperature (°C)	0 - 40		
Operating Relative Humidity (Non-condensing) (%)	0 - 95		
Online Thermal Dissipation (BTU/hr)	20	24	
Certifications			
Certifications*	CE, EAC, RCM		
RoHS	Yes		

*Certifications may vary according to different regions. Visit www.cyberpower.com for more information.
#All specifications are subject to change without notice.